



The Benefactor is perfectly situated behind the tee box of THE PLAYERS Stadium Course's famous Island Green. This upscale environment includes two levels for entertaining with interior table seating and exterior stadium seating. The Benefactor ticket, which sold out in 2009, is one of the most valued tickets at THE PLAYERS. A limited number of new accounts are being added for 2010.

THE BENEFACTOR PROVIDES:

- Access to The Benefactor, the TPC Sawgrass Clubhouse, The Turn and Grounds
- Upscale food and premium bar available for purchase
- Televisions and courtesy telephones
- Complimentary Daily Pairings Sheets
- ShotLink® Scoring System
- Private restroom facilities
- **This investment may be deductible as an entertainment expense incurred in conjunction with a charitable sporting event. Please consult your tax advisor.**

Package Includes:

- Admission for 30 guests per day, Monday – Sunday
- Additional 10 Grounds admission tickets per day, Monday – Sunday
- 4 VIP parking passes per day, Monday – Sunday
- 12 Preferred parking passes per day, Monday – Sunday
- Social Membership for one year to TPC Sawgrass (includes golf access)
- Gift Certificate to TPC Sawgrass Golf Shop
- 2 invitations (for 2 people) to THE PLAYERS Charity Celebration



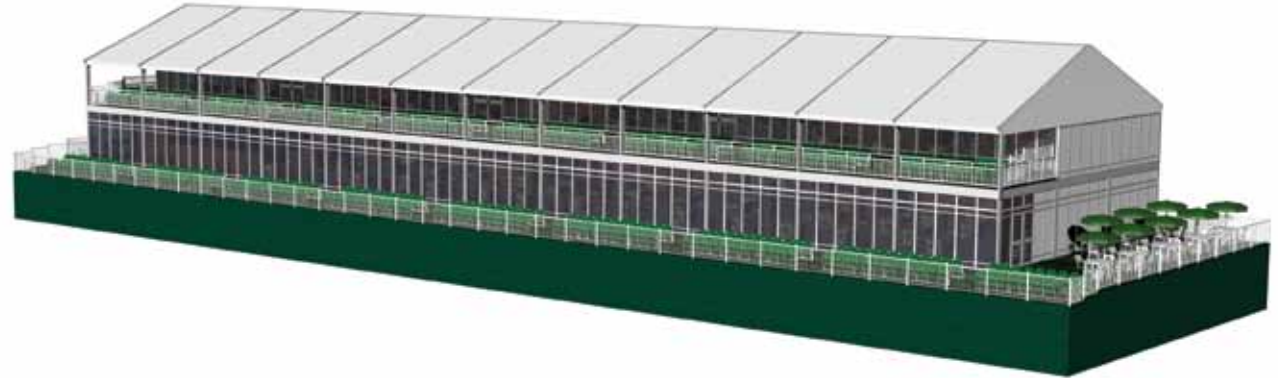

2nd Level

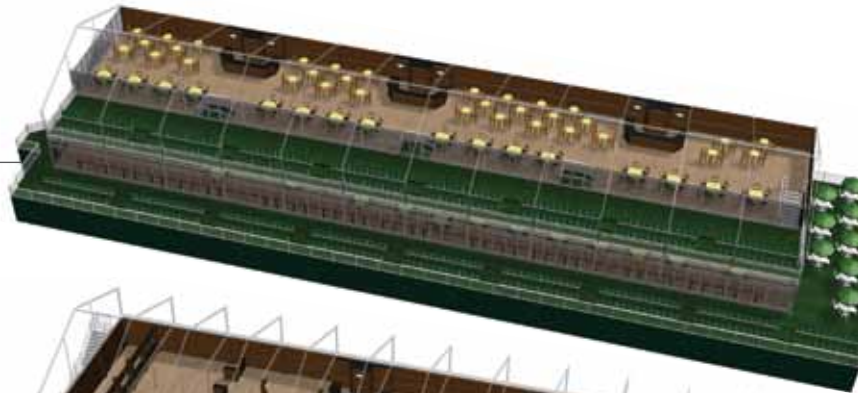

1st Level

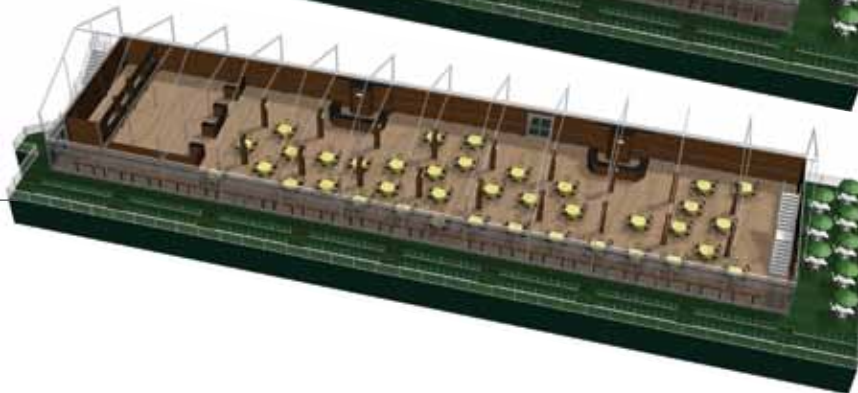

Together, anything's possible.

The biggest winners at THE PLAYERS Championship are the charities who benefit from the tournament's net proceeds. Since 1977, when THE PLAYERS moved to Ponte Vedra Beach, more than \$34 million has been contributed to Northeast Florida charities as a result of the tournament, including more than \$3 million in 2009. By supporting the PGA TOUR and THE PLAYERS, you are supporting local charities.

Ask us about early bookings
and multi-year pricing!

SPONSORED BY PGA TOUR, INC., DEPARTMENT OF AGRICULTURE DIVISION OF CONSUMER SERVICES REGISTRATION NUMBER CH8173, PURSUANT TO CHAPTER 496 OF THE FLORIDA STATUTES. A COPY OF THE OFFICIAL REGISTRATION AND FINANCIAL INFORMATION MAY BE OBTAINED FROM THE DIVISION OF CONSUMER SERVICES BY CALLING (800) 435-7352 TOLL-FREE WITHIN THE STATE OF FLORIDA. FOR OUTSIDE THE STATE OF FLORIDA, CALL (850) 488-2221. REGISTRATION DOES NOT IMPLY ENDORSEMENT, APPROVAL OR RECOMMENDATION BY THE STATE. THE PACKAGE PURCHASE IS NOT TAX DEDUCTIBLE AS A CHARITABLE CONTRIBUTION BY THE CONSUMER. THE INVESTMENT MAY QUALIFY FOR A 100% DEDUCTION AS AN ENTERTAINMENT EXPENSE INCURRED IN CONNECTION WITH A CHARITABLE SPORTING EVENT. PLEASE CONSULT YOUR TAX ADVISOR.

To learn more, call 904.280.4722 or visit PGATOUR.COM